

\$989,900 - 3366 Rt 22, Branchburg Twp.

MLS® #3892761

\$989,900

Bedroom, Bathroom, 291,852 sqft
Commercial on 0 Acres

N/A, Branchburg Twp., NJ

UNBELIEVABLE: 6.70 ACRES ON RT 22 WEST LOCATED IN THE O/LD ZONE (OFFICE ZONE AND LOW DENSITY RESIDENTIAL) IN BRANCHBURG, A PRESTIGIOUS SOMERSET COUNTY LOCATION, PERMITTED USES PROFESSIONAL OFFICES, MEDICAL OFFICES, CHILD CARE, THE SITE IS SERVICED BY ALL PUBLIC UTILITIES INCLUDING WATER, SEWER, ELECTRIC & GAS, EXCELLENT DEMOGRAPHICS, 34,000 CARS A DAY PASS THIS SITE LOT # 6.02 & 6.03

Built in 9999

Essential Information

MLS® #	3892761
Price	\$989,900
Square Footage	291,852
Acres	0.00
Year Built	9999
Type	Commercial
Status	Active

Community Information

Address	3366 Rt 22
Subdivision	N/A
City	Branchburg Twp.
County	Somerset
State	NJ

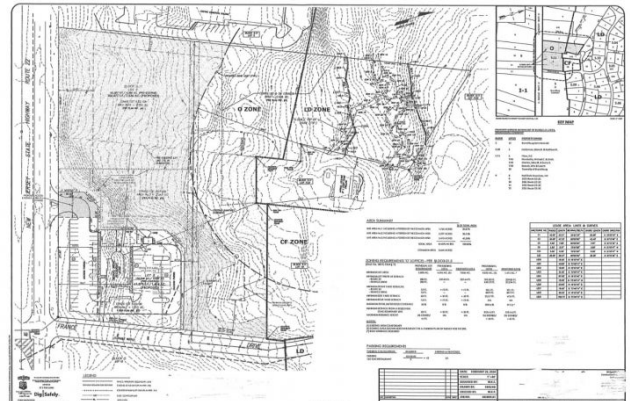

Zip Code 08876

Amenities

Utilities Electric, Gas-Natural
Parking See Remarks

Interior

Heating See Remarks

Exterior

Exterior See Remarks
Roof See Remarks

Additional Information

Date Listed March 25th, 2024
Days on Market 53
Zoning O/LD

Listing Details

BHHS FOX & ROACH

The data relating to real estate for sale on this website comes in part from the IDX Program of Garden State Multiple Listing Service, L.L.C. Real estate listings held by other brokerage firms are marked as IDX Listing. Information deemed reliable but not guaranteed. Copyright © 2024 Garden State Multiple Listing Service, L.L.C. All rights reserved. Notice: The dissemination of listings on this website does not constitute the consent required by N.J.A.C. 11:5.6.1 (n) for the advertisement of listings exclusively for sale by another broker. Any such consent must be obtained in writing from the listing broker. This information is being provided for Consumers' personal, non-commercial use and may not be used for any purpose other than to identify prospective properties Consumers may be interested in purchasing.
Listing information last updated on May 18th, 2024 at 2:48am EDT